

# Ready-built Warehouse

## Vinh Loc 2

PROJECT INFORMATION	
GFA (sqm)	Lot A: 100,000 sqm Lot C: 112,000 sqm
Minimum Leasable Area (sqm)	Lot A: From 5,000sqm or above Lot C: From 5,000sq or above
Clear Height	GF: 9.0m 2F: 9.0m
Floor Loading	GF: 3 tons per sqm 2F: 2.5 tons per sqm
Floor details	Elevated floor 1.3 meters high
Loading bay	Loading bay 4.5m with canopy (Lot A: 6m, Lot C: 12m)
Fire-fighting	Standard
Office	Lot A: 4,680 sqm Lot C: 6,336 sqm
Parking	For container, car and motorbike

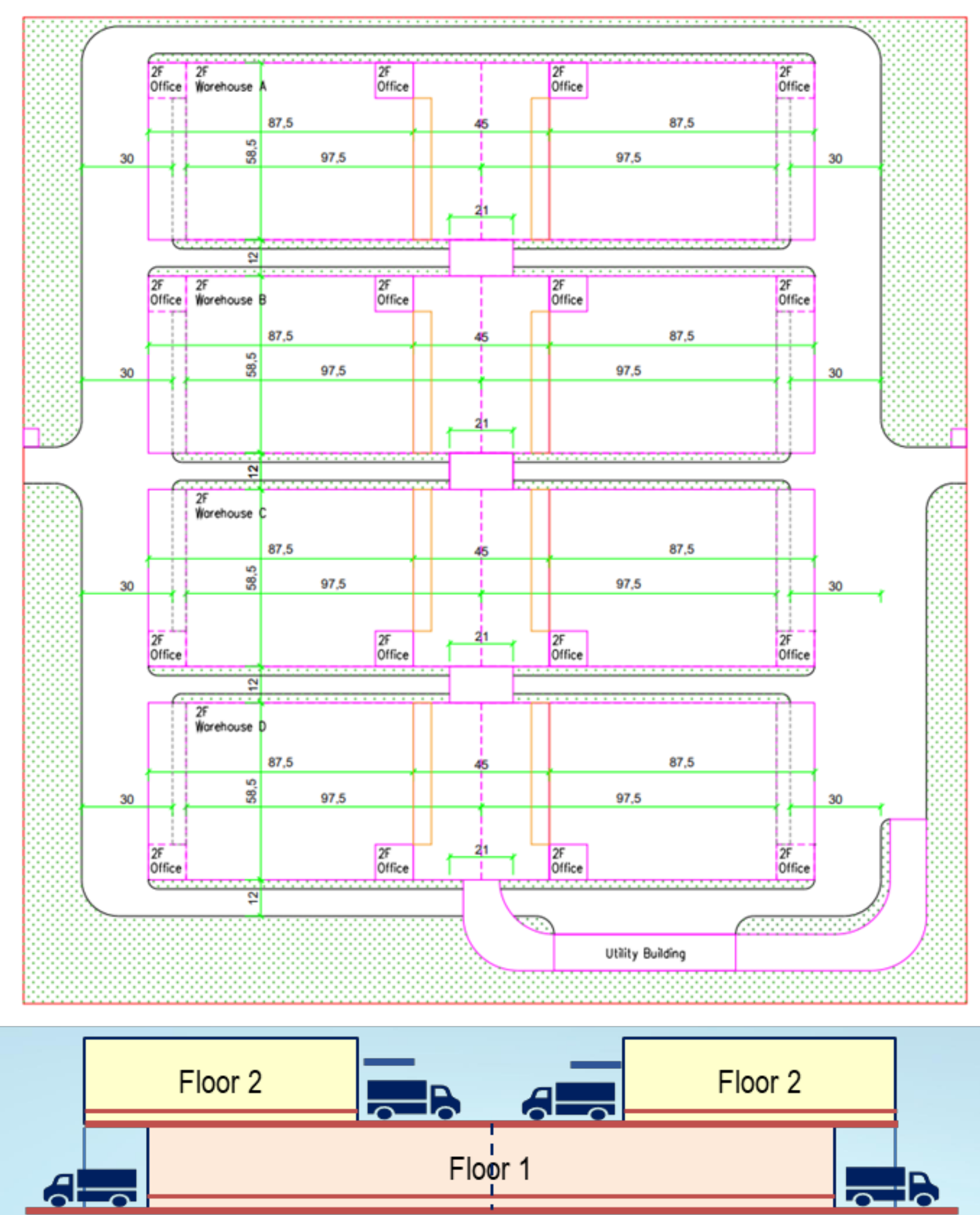

Note: WH is planned to build 2-storey RBW with ramp. (Lot A lay-out)